



MT125-4VM

Reciprocating compressors with mineral oil for R22, MBP & HBPMotor voltage code 4,380-400V/3/50Hz - 460V/3/60Hz.

> **Product specifications**
 > **Dimensions**
 > **Contact**

> **Code number selector**
 > **Literature (8)**



0

Characteristic	Value
Type	MT
Weight	
01. Model number (on compressor nameplate)	MT125HU4DVE
02. Suction connection	1-3/4" Rotolock
03. Discharge connection	1-1/4" Rotolock
04. Suction connection with supplied sleeve	1-1/8" ODF
05. Discharge connection with supplied sleeve	3/4" ODF
06. Oil sight glass	Threaded
07. Oil equalisation connection	3/8" flare SAE
08. Oil drain connection	None
09. LP gauge port	Schrader
10. Internal pressure relief valve	30 bar / 8 bar
11. Cylinders	-
12. Swept volume	215.4 cm ³ /rev
13. Displacement at 50 Hz	37.5 m ³ /h
14. Displacement at 60 Hz	45.2 m ³ /h
15. Nominal speed at 50 Hz	2900 rpm
16. Nominal speed at 60 Hz	3600 rpm
17. Nominal voltage at 50 Hz	380-400V/3/50Hz
18. Nominal voltage at 60 Hz	460V/3/60Hz
19. Voltage range at 50 Hz	340-440 V
20. Voltage range at 60 Hz	414-506 V
21. Winding resistance (between phases)	1.57 Ohm
22. Winding resistance (between phases 1-2)	1.57 Ohm
23. Winding resistance (between phases 1-3)	1.57 Ohm
24. Winding resistance (between phases 2-3)	1.57 Ohm
25. Main winding resistance	-

26. Start winding resistance	-
27. Maximum Continuous Current (MCC)	27 A
28. Maximum Must Trip current (MMT)	-
29. Locked Rotor Current (LRA)	105 A
30. Motor protection	Internal overload protector
31. Net weight	64 kg
32. Oil charge	4 litre
33. Oil type	Mineral - 160P
34. Approved refrigerants	R22, R417A-160PZ
35. Refrigerant charge limit	10 kg
36. Approvals (CE)	CE certified
37. Approvals (UL)	UL certified (file SA6873)
38. Approvals (CCC)	-
39. Maximum system test pressure LP side	25 bar(g)
40. Maximum system test pressure HP side	30 bar(g)
41. Maximum differential test pressure	30 bar
42. Maximum number of starts per hour	12
43. Packaging	Industrial pack
44. Pack quantity	6
45. Parts shipped with compressor	Suction & Discharge solder sleeves, rotolock nuts and gaskets
46. Parts shipped with compressor	Mounting kit with grommets, bolts, nuts, sleeves and washers
47. Parts shipped with compressor	-

OUTLINE DRAWINGS

4 cylinders

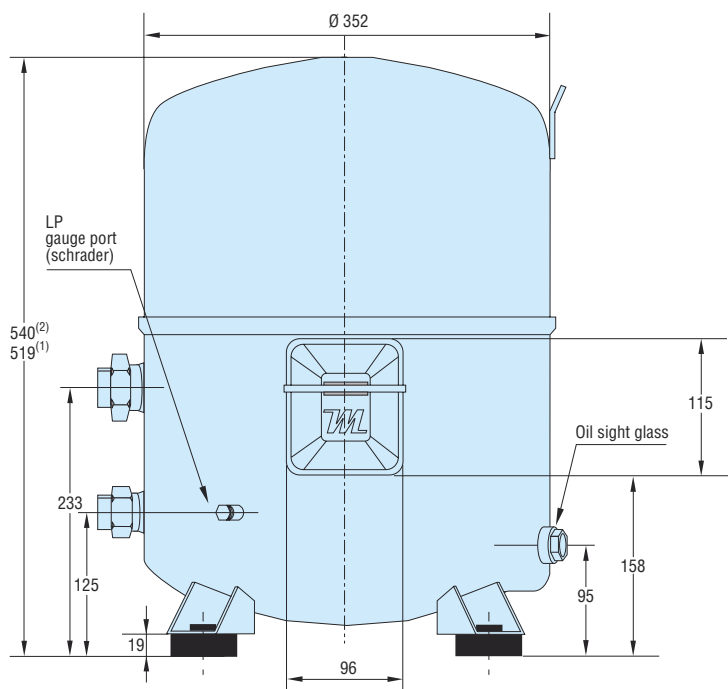
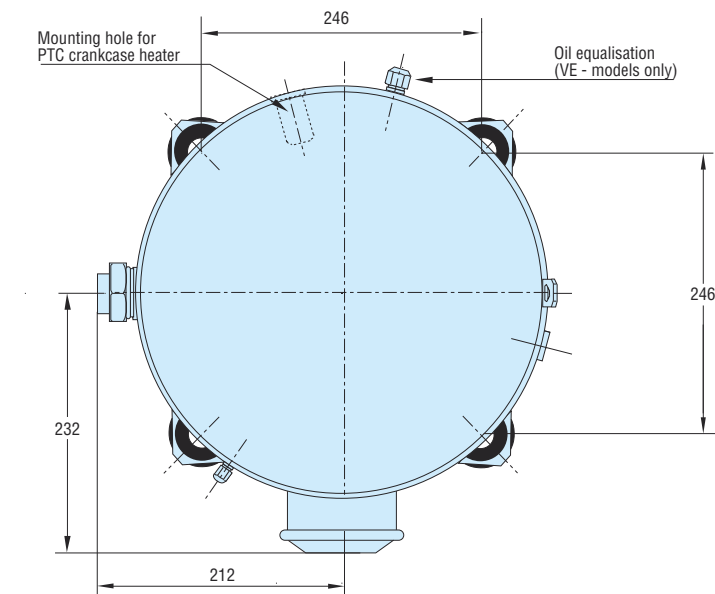

(1) MTZ 100, 125
(2) MTZ 144, 160

Terminal box

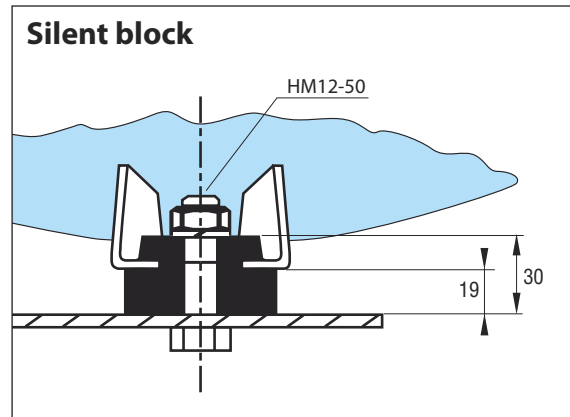
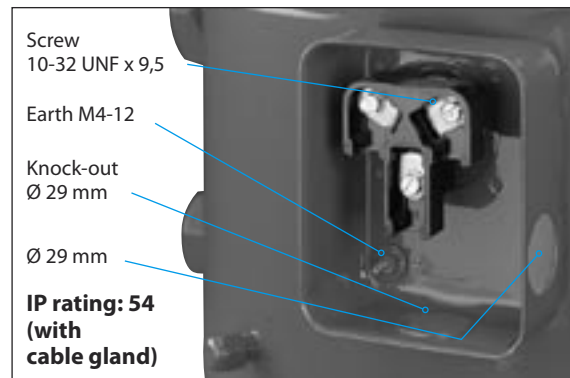

	Rotolock connections size		Pipe sizing		Rotolock valve	
	Suction	Discharge	Suction	Discharge	Suction	Discharge
MT/MTZ100 MT/MTZ125 MT/MTZ144 MT/MTZ160	1"3/4	1"1/4	1"1/8"	3/4"	V02	V04